

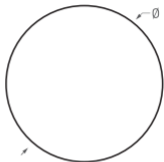







# mod.1060

RESIN



Ref.	Cod.	∅	H	
 1060.50.02	1060AZ	50	30	12
 1060.50.05	1060MA	50	30	12
 1060.50.08	1060NE	50	30	12
 1060.50.10	1060RJ	50	30	12
 1060.50.20	1060AB	50	30	12
 1060.50.41	1060CR	50	30	12
 1060.50.36	1060AN	50	30	12